

**27,000 ± SQ. FT. WAREHOUSE/DISTRIBUTION FACILITY**

# **107 STONEHURST CT**

**NORTHVALE, NJ**

**Eric Lewin**

Office (201) 438-1177

Mobile (201) 832-4569

[elewin@teamresourcesinc.com](mailto:elewin@teamresourcesinc.com)

**Stacey Wellins**

Office (201) 438-1177

Mobile (914) 907-4095

[swellins@teamresourcesinc.com](mailto:swellins@teamresourcesinc.com)



**105-107 Stonehurst Ct. // NORTHVALE, NJ**

**Team Resources**, as exclusive agent, is pleased to present this 27,000 +/- sf (including office) industrial unit.

**PROXIMITY TO KEY LOCATIONS**

Port Newark 29 +/- miles NJ Turnpike 26 +/- miles  
Lincoln Tunnel 23 +/- miles GW Bridge 14 +/- miles

**CONTACT EXCLUSIVE BROKER****ERIC LEWIN**

Mobile: (201) 832-4569

elewin@teamresourcesinc.com

**STACEY WELLINS**

Mobile: (914) 907-4095

swellins@teamresourcesinc.com

**Property Description**

<b>Available:</b>	27,000 +/- sq. ft.
<b>Building Size:</b>	65,000 +/- sq. ft.
<b>Office Space:</b>	3,000 +/- sq. ft.
<b>Ceiling Height:</b>	18' clear
<b>Power:</b>	400a/280v
<b>Loading:</b>	5 tailboard doors
<b>Parking:</b>	10 cars, 5 trucks
<b>Asking Rental:</b>	Upon request
<b>Tax &amp; CAM:</b>	\$2.08 + \$0.61 psf
<b>Occupancy:</b>	09/01/25

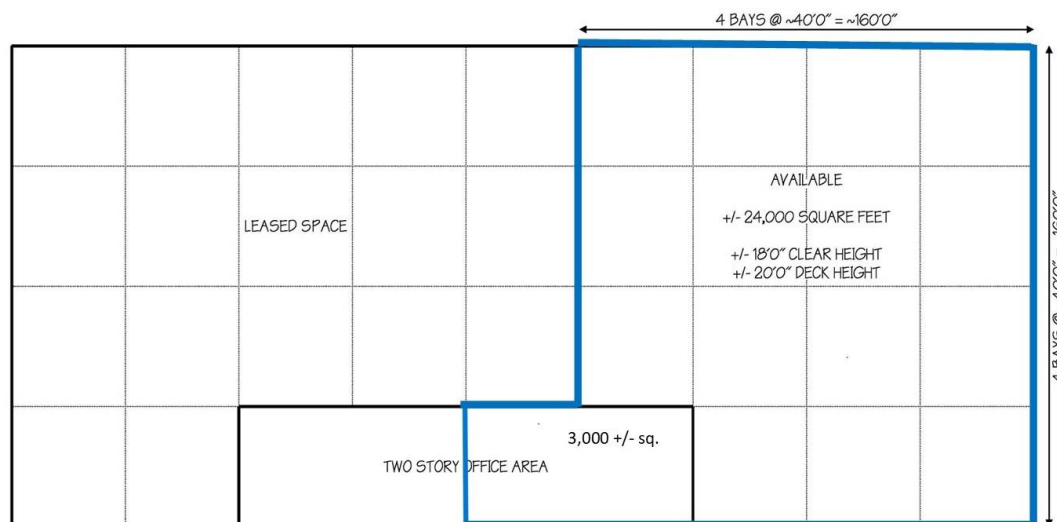





**CONTACT EXCLUSIVE BROKER**

**ERIC LEWIN**

Mobile: (201) 832-4569

elewin@teamresourcesinc.com

**STACEY WELLINS**

Mobile: (914) 907-4095

swellins@teamresourcesinc.com

