

FOR LEASE

18-01 POLLITT DRIVE

FAIR LAWN, NJ



5,677 +/- SQ. FT. OFFICE / INDUSTRIAL / MEDICAL / RECREATIONAL SPACE

CONTACT EXCLUSIVE BROKER

Greg Sholom

Mobile (201) 755-2628

gsholom@teamresourcesinc.com

David Cantor

Mobile (201) 314-2495

dcantor@teamresourcesinc.com



18-01 Pollitt Drive // Fair Lawn, NJ

Team Resources, as exclusive agent, is pleased to present this property of 5,677 +/- Sq. Ft. for Lease. Zoned Light Industrial.



PROXIMITY TO KEY LOCATIONS

Just off Route 208. Easy access to Routes 4, 17 and Garden State Parkway.

CONTACT EXCLUSIVE BROKER

Greg Sholom

Mobile (201) 755-2628
gsholom@teamresourcesinc.com

David Cantor

Mobile (201)314-2495
dcantor@teamresourcesinc.com



Property Description

Acreeage:	9.4 +/- acres
Available Space:	5.677 +/- sq. ft.
Total Building Space:	144,000 +/- sq. ft.
Ceiling Height:	14'7" clear
Loading Doors:	1 tailboard door
Parking:	Ample
Sprinklers:	Wet
Lease Price:	Upon Request
Comments:	Can be used for warehouse space, medical, medical or recreational.

18-01 Pollitt Drive // Fair Lawn, NJ

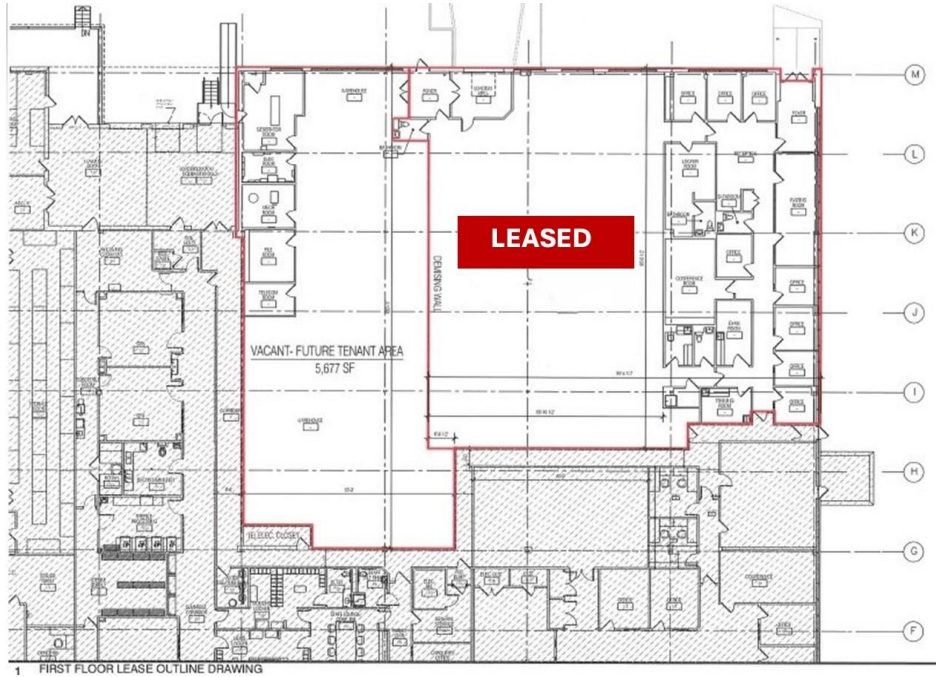

CONTACT EXCLUSIVE BROKER

Greg Sholom

Mobile (201) 755-2628

gsholom@teamresourcesinc.com

David Cantor

Mobile (201)314-2495

dcantor@teamresourcesinc.com

