

FOR REFERENCED ONLY	
WAREHOUSE	21,688 GSF
OFFICE (1ST FLOOR)	4,483 GSF
OFFICE (2ND FLOOR)	4,115 GSF
TOTAL BUILDING	+/- 30,286 GSF

344 BROAD AVENUE
LEONIA, NEW JERSEY 07605
TEL 201 461 5154

PULICE / WILLIAMS ARCHITECTS

PROJECT
PATTI LLC WAREHOUSE
100 STONEHURST COURT
NORTHVALE, NEW JERSEY 07647
DRAWING TITLE
FIRST FLOOR

REVISION

DATE
12.21.2020

SCALE
AS NOTED

SHEET NUMBER

A1

This document and the ideas and designs incorporated herein, are the property of PULICE / WILLIAMS ARCHITECTS. It is to be used only for the project and site for which it was prepared. No other use or reproduction is permitted without the written consent of PULICE / WILLIAMS ARCHITECTS.

CS6541 - NJ

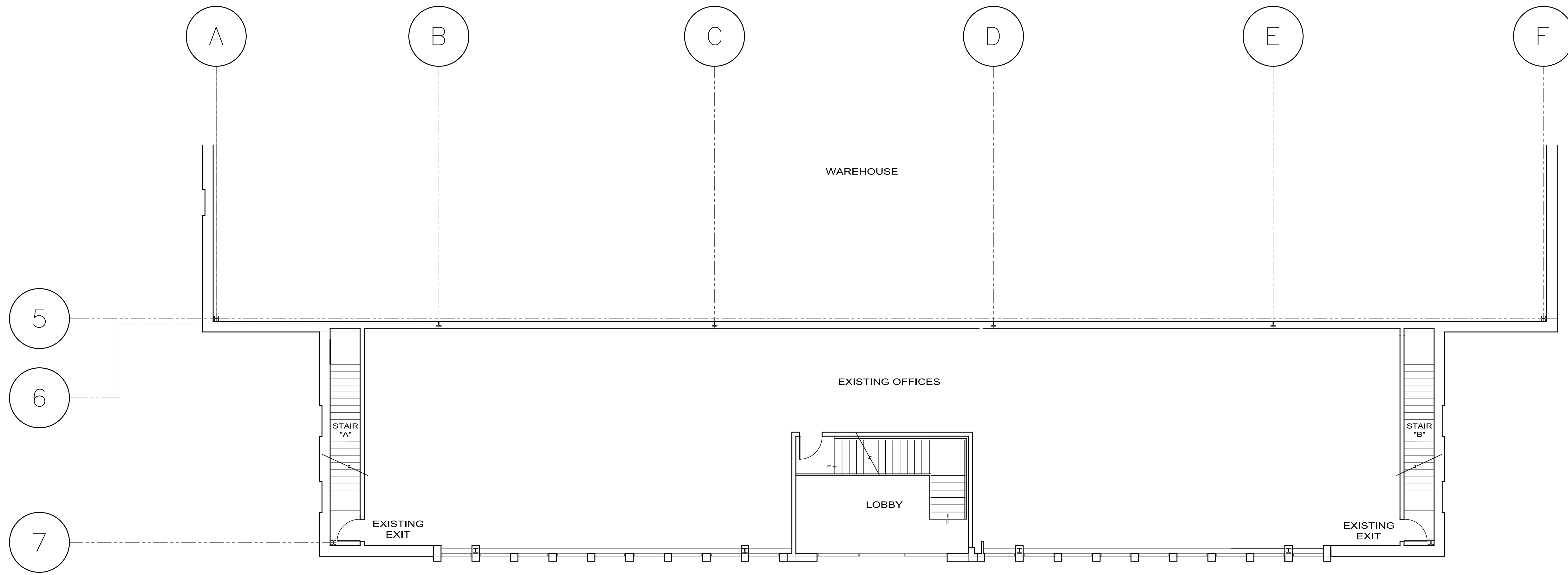

A SECOND FLOOR
1/8" = 1'-0"

FOR REFERENCED ONLY

WAREHOUSE	21,688 GSF
OFFICE (1ST FLOOR)	4,483 GSF
OFFICE (2ND FLOOR)	4,115 GSF
TOTAL BUILDING	+/- 30,286 GSF

SHEET NUMBER

A2

REVISION

DATE
12.21.2020

SCALE
AS NOTED

PROJECT

PATTI LLC WAREHOUSE
100 STONEHURST COURT
NORTHVALE, NEW JERSEY 07647

DRAWING TITLE

SECOND FLOOR

PULICE / WILLIAMS ARCHITECTS



344 BROAD AVENUE
LEONIA, NEW JERSEY 07605
TEL 201 461 5154

The documents and the items and design incorporated herein are an instrument of service and shall remain the property of PULICE / WILLIAMS ARCHITECTS. No part of this document may be reproduced or transmitted in any form or by any means, electronic, mechanical, photocopying, recording, or by any information storage and retrieval system, without the prior written permission of PULICE / WILLIAMS ARCHITECTS.