

LOT AREA	224,412 SF
OPEN SPACE AREA	34,342 SF
PERCENTAGE OPEN SPACE	15.30%
VEHICULAR USE AREA	64,032 SF

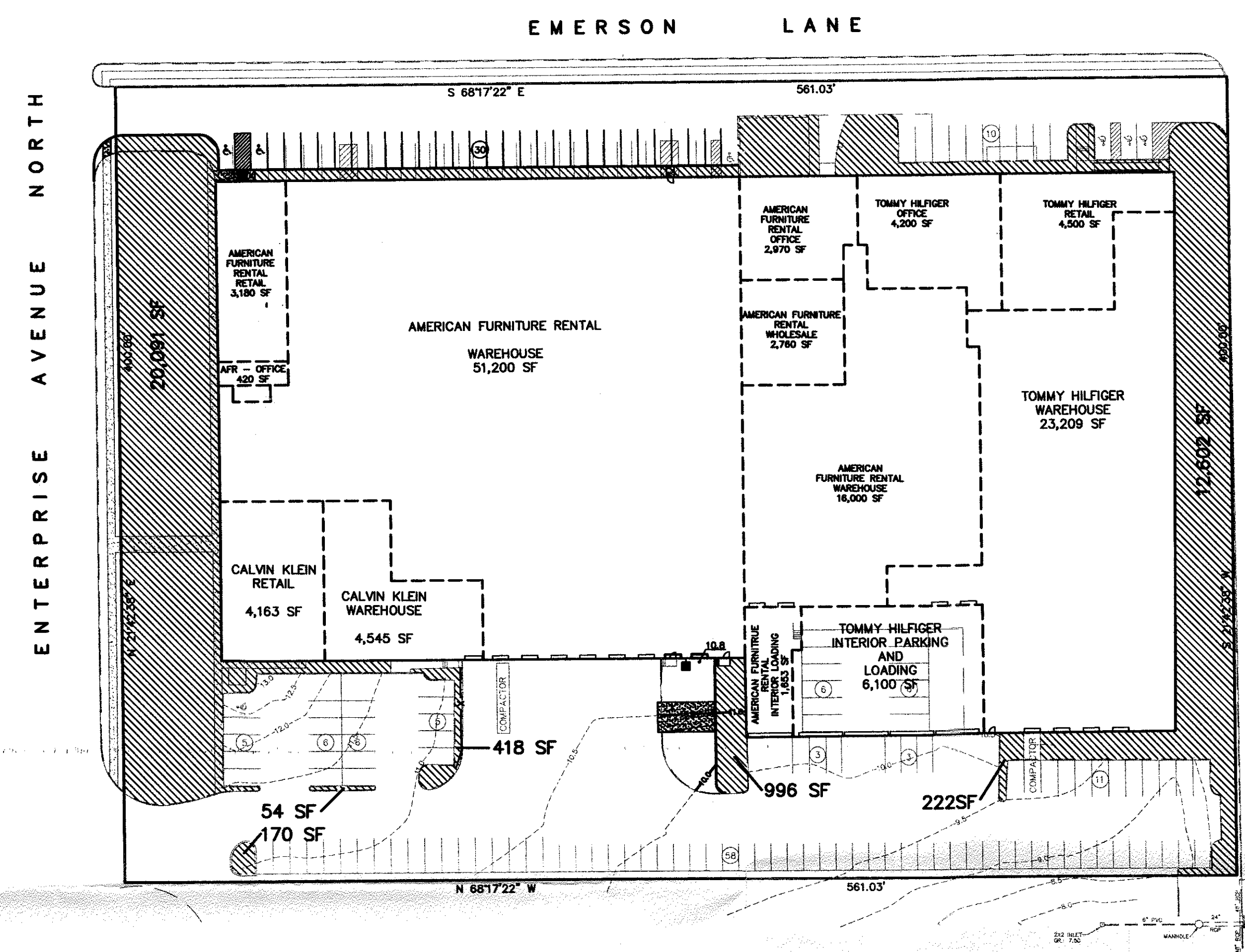
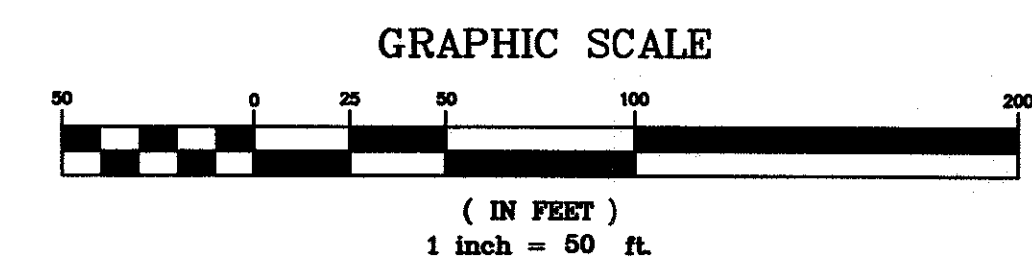

LOT AREA	224,412 SF
OPEN SPACE AREA	34,553 SF
PERCENTAGE OPEN SPACE	15.40%
VEHICULAR USE AREA	63,689 SF

ZC-07-740 Hartz Lindenbaum/A.F.R. - Loading Docks  
**NEW JERSEY MEADOWLANDS COMMISSION**  
 APPROVED  
 Zoning approval for:  
 1. Opening of two existing loading docks.  
 2. Installation of asphalt pavement; concrete sidewalk, curb and curb ramps; landscaping; striping and fencing.  
 Nicholas Agnoli, P.E., P.F.  
 Chief Engineer  
 05/02/08

THIS DRAWING IS INTENDED TO BE USED FOR BIDDING AND REFERENCE PURPOSES ONLY. DRAWING SHALL NOT BE USED FOR CONSTRUCTION WITHOUT THE PROFESSIONAL ENGINEER'S RAISED SEAL AND SIGNATURE AND THE WORDS "ISSUED FOR CONSTRUCTION".

ANY DIFFERENCES BETWEEN FIELD CONDITIONS AND THOSE SHOWN ON THESE PLANS SHALL BE BROUGHT TO THE ATTENTION OF MACDEL ENGINEERING.

#	DATE	REVISIONS	PG	BY
1.	05-01-08	CHANGED LOCATION OF HANDICAP PARKING SPACE	PG	

David L. Beesley  
 Professional Engineer  
 New Jersey License No. 28144

PROJECT: **PROPOSED AMERICAN FURNITURE RENTAL EXPANSION**

LOCATION: **LOT 6, BLOCK 57 TOWN OF SECAUCUS HUDSON COUNTY, NEW JERSEY**

DRAWING TITLE: **OPEN SPACE PLAN**

**Macdel Engineering, P.C.**  
 Civil Engineers and Land Surveyors  
 969 Paulison Avenue  
 Clifton, New Jersey 07011-3629  
 tel 973.478.2000  
 fax 973.478.5173  
 engineers@macdel.com

DESIGNED D. Beesley	DRAWN P. Garcia	CHECKED D. Beesley	DATE 03-04-08	SHEET NUMBER: <b>SP-2</b>
FIELD BOOK	DWG FILE 20080010S	JOB NUMBER 2008001	SCALE 1"=50'	

© Macdel Engineering, P.C. W:\2008\2008001\CURRENT\2008001.GSD.DWG May 01, 2008 - 12:57pm gpatna